

This user guide contains essential information in relation to safe use and maintenance and should be retained with the shower trolley for reference

ShowerTrolley



User Guide

TRT1 Height Adjustable - Hydraulic

TRT2 Static Height

TRT3 Paediatric Height Adjustable - Hydraulic

TRT4 Height Adjustable - Electric

ShowerTrolley

Contents

Safety Considerations	1
Operating Instruction	2
Applying the Brakes.....	3
Latch Operation & Adjustment.....	4
Cleaning & Maintenance	5
Charging the TRT4	5
Spare Parts.....	6-7
Troubleshooting.....	8
Warranty	9

These products have been designed to the highest standards with safety, strength and quality in mind.

Follow the recommendations in this guide to ensure maximum benefit from your shower trolley.

Your Chiltern Invadex shower trolley has been designed and tested to meet the highest standards of safety. Read the safety section of this guide prior to use, this is contained on page 1.

Safety Considerations



This section should be read and understood prior to use of the shower trolley. Failure to adhere to the below can lead to serious injury. Should clarification of any point be required, please call Chiltern Invadex on 01869 365500 prior to use.

- Ensure that all users read this guide before operating the shower trolley.
- Maximum user weight of 190kg (30 stone) must not be exceeded.
- Prior to each use, inspect the shower trolley sides and brackets for signs of distortion or damage. The trolley must not be used if any damage is observed.
- Under no circumstances should a client be left alone in the shower trolley.
- Although fitted with castors, these are to enable ease of movement of the trolley the device is not intended to be used for patient transportation.
- The trolley is a showering aid and is not intended for use as a bath. The shower trolley must not be filled with water, as such no plug is provided and one should not be sourced elsewhere.
- Where the trolley is to be used by multiple bathers, cleaning with a medical disinfectant to prevent cross contamination is strongly recommended. (follow the maintenance schedule on page 5).
- The lift/transfer of the client should be assessed and planned by a trained person.
- Any damage to the TRT4 electric actuator or charger should be reported immediately and the trolley removed from use until repaired.
- The TRT4 should be subjected to a PAT test at least annually.
- It is recommended that shower trolleys are serviced by a qualified engineer at least annually, six monthly in areas of high use (eg nursing homes).



Where there is any doubt as to the safety of the trolley it should be removed from use pending inspection by a competent person.

Operating Instruction

1. Position the shower trolley near to the showering facility and locate the outlet pipe into a suitable waste.
2. Prior to use, inspect the shower trolley for signs of distortion on the cot sides or latches. If the item is damaged it should be considered unsafe and replaced. The shower trolley itself must not be used if there is any sign of damage.
3. The trolley is designed to be angled to allow water run off through the outlet pipe. To ensure that water does not congregate around the users head, ensure that the liner is inserted correctly. (ie that the outlet pipe is located at the lower end of the trolley when the trolley is raised.)
4. Ensure that the brakes are in the ON position prior to attempting any transfer and remain ON whilst the trolley is occupied. (see page 3)
5. Position the trolley bed to its lowest position by depressing the down foot pedal or the down button on the hand control for the electric (TRT4) model.
Note: the lower speed has been carefully set to provide a safe and controlled lower speed. Application of force to the top of the cot side in an attempt to increase the speed can result in serious damage to the cot side and the actuator.
6. Pull the latch lever down to release the cot side.
Note: cot sides lower on both sides of the trolley, where one side of the trolley is unattended the latch must be checked prior to use to ensure that it is secure and will not release during use (see page 4).
7. Unclip the poppers on the corners of the liner and lay the liner flat.
8. Position the bather onto the shower liner.
Note: prior to attempting any transfer the action should be planned and prepared.
9. Refix the shower liner corners and reposition the cot side.
Note: ensure that latch locks securely into place. (see page 4)
10. Raise the trolley to a suitable height by depressing the up pedal or the up button on the hand control for the electric (TRT4) model.
11. Proceed with bathing.
12. When bathing is complete remove the bather by repeating operations 5-7 in reverse. Brakes must be applied.
13. Where the shower trolley is to be used by multiple bathers it is strongly recommended that the trolley is cleaned after each use using a medical disinfectant (see page 5)
14. The TRT4 electric actuator should be charged in accordance with the instructions on page 5.

Never leave a user unattended in the shower trolley

**A wall poster showing user instruction is available upon request to
technical@chilterninvadex.co.uk.**

Applying the Brakes

To ensure the safety of both the end user and the carers, the braked castors should be checked for damage prior to each use and applied during transfer and when in use.

As standard, shower trolleys have 4 braked castors. Braked castors are indicated by a **GREY** locking lever.

Where requested at manufacturer, 3 braked and 1 directional lock castor. A directional lock castor is indicated by a **GREEN** locking lever.

The brakes are applied/release as shown below;

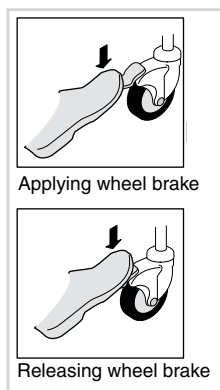

The directional lock castor is indicated by a **GREEN** locking lever.

When applied (in the same manner as shown above) it is important to note that the directional lock is not a brake it will lock the trolley into a straight steering position but will not prevent movement.

Please note: only one directional locking castor should be fitted to the trolley, should more than one be observed this should be reported to the service/maintenance contractor.

Latch Operation & Adjustment

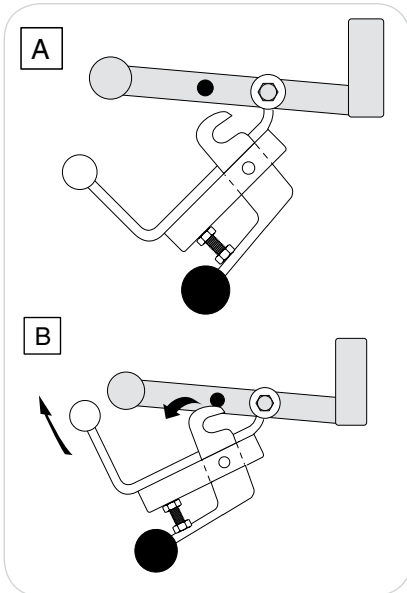

1.

As the side rail of the trolley is lifted, the latch makes contact with the locating pin. As you continue to lift the latch opens and finally clicks over the pin. As shown in A & B.

There should be no reason to open the latch manually to achieve closure.

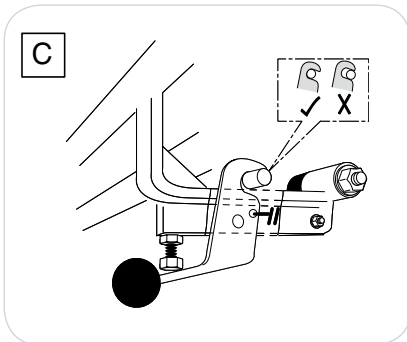

2.

When the side rail is vertical, the latch should be fully engaged as shown in C.

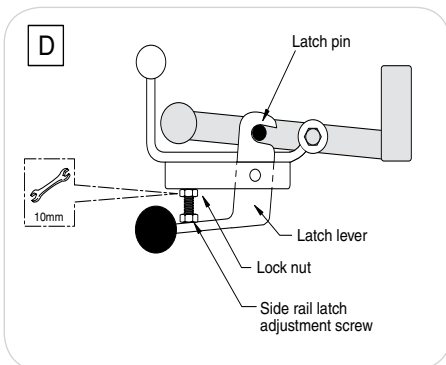

3.

If the latch is only partially engaged, the adjusting screw is too far out.

If the latch does not open automatically the screw needs adjusting outwards. A small amount of silicone grease on the top of the latch will assist with the automatic action. When any adjustment is made the lock nut must be fully tightened. See figure D.

Cleaning & Maintenance

Prior to Use

Check cot sides and latches are secure and undamaged.

After Use

Rinse the unit, particularly the bathing area with warm clean water. Use a non abrasive cleaner if soiled. For institutional use where the device is to be used by multiple bathers it is strongly recommended that a medical disinfectant is used. Contact your infection control officer for details of disinfectants approved for this use by your institution.

Weekly

Thoroughly clean the unit, particularly the bathing area with warm clean water and a non abrasive cleaner. For institutional use where the device is to be used by multiple bathers it is strongly recommended that a medical disinfectant is used. Contact your infection control officer for details of disinfectants approved for this use by your institution.

Monthly

Flush the waste pipe with a disinfectant to help avoid cross contamination.

Yearly

It is recommended that the device is serviced at least annually by a qualified engineer.

The TRT4 electric trolley should be PAT tested on an annual basis.

Re-issue

Where a trolley is owned by a loan store or other authority where it is likely to be re-issued. It is recommended that the item is fully disinfected (or a new liner obtained) and subjected to a full service prior to issue.

For details of qualified service engineers please contact Chiltern Invadex.

Charging the TRT4

It is recommended that the battery pack is fully charged prior to first use. Charging time from flat to full is approx 4 hrs.

The batteries are charged through the handset by connecting the power lead to the handset as shown.

Whilst charging the LED on the charger will flash orange and will change to green once fully charged.

It is recommended that the battery pack is charged at least weekly in domestic use, or daily in institutional use.



When the battery is running low an audible bleep will sound as a warning that the trolley should be recharged.



The handset is IP51 rated, however to prevent damage it should be protected from water ingress and should not be submersed in water.

The trolley should not be charged whilst in the bathroom or any other wet environment.

Spare Parts

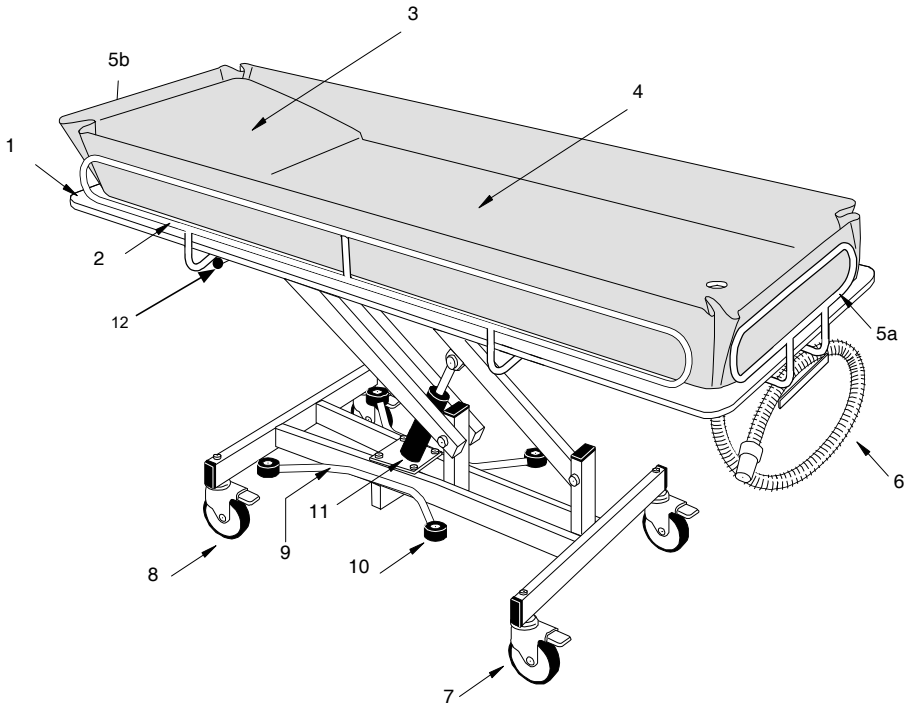

Item	Description	Part number	Model
1a	*Plastic top - Standard length (1930mm)	TRTS012	T1, T2 & T4
1b	*Plastic top - Paediatric (1600mm)	TRTS015	T3
1c	*Plastic top - Bespoke	TRTS013	T1, 2, 3 & 4 SPEC
2a	*Cot side - Standard length	TRTS032	T1, T2 & T4
2b	*Cot side - Paediatric	TRTS038	T3
3	**Wedge cushion	TRTS003	All
4a	**Trolley liner - Standard length	TRTS001V	T1, T2 & T4
4b	**Trolley liner - Paediatric	TRTS009V	T3
4c	**Trolley liner - Bespoke	TRTS002V	T1, 2, 3 & 4 SPEC
5a	*Cot end - Waste pipe end	TRTS033	All
5b	*Cot end - Head end	TRTS036	All

6a	Waste outlet pipe - standard length (1m)	TRTS010	All
6b	Waste outlet pipe - Bespoke	TRTS014	All
6c	Backnut (waste hose)	CH0400	All
7	*5" Braked castor	202-00031	All
8	*5" Straight steering castor	202-00030	All
9	*Foot pedal assembly	TRTS004	T1 & T3
10	Foot pedal rubber	CH0181	T1 & T3
11	*Hydraulic ram	TRTS006	T1 & T3
12	*Cot side latch assembly	TRA017	All
Electric model only			
*Electric actuator		TRTS026	T4
Control/battery box		TRTS027	T4
Charger		TRTS029	T4
Handcontrol		CH0653	T4

In the interests of user safety it is recommended that parts indicated * should be installed by a qualified engineer

**Part numbers supplied are for standard Grey fabric, if your fabric is any other colour please call as this would indicate a special item.

Troubleshooting

Symptom	Suggested Cause	Solution
Hydraulic Models		
Shower trolley will not raise	Hydraulic unit failure	Call out required
Shower trolley will not lower	Obstruction	Clear obstruction
	Hydraulic unit failure	Call out required
Shower trolley will not stay at desired height	Pedal is sticking	Clean pedal and check for free movement
	Hydraulic unit failure	Call out required
Electric Model		
Shower trolley will not raise or lower	Battery power is low	Charge batteries, see page 5
Shower trolley will not raise	Handset or actuator failure	Call out required
Shower trolley will not lower	Obstruction	Clear obstruction
	Handset or actuator failure	Call out required
Shower trolley will not stay at desired height	Actuator fault	Call out required
All Models		
Cot side will not move	Weight against cot side or hinges jammed	Push cot side inwards before trying to release the catch.
		Lubricate the hinges
Cot sides will not lock into position	Latch screw requires adjustment	Refer to page 4
	Cot sides are damaged	Call out required
Water leaks	Liner or waste hose are damaged	Check for damage and replace
	Waste hose is not in waste outlet	Check that the hose is securely fitted into the outlet

For further advice and guidance please contact Chiltern Invadex on 01869 365500 or at technical@chilterninvadex.co.uk.

To arrange a service call out please contact our service department on 01869 365500 Opt 3 or at servicedept@chilterninvadex.co.uk.



If there is any doubt about the condition of the trolley it must be discontinued from use until a service call has been completed.

Warranty

Your Chiltern Invadex Shower Trolley carries a 12 month warranty from the date of purchase, subject to the following conditions;

1. Should you experience any problems with our workmanship or materials within the first 12 month period please contact your point of purchase.
2. Repairs made during the warranty period will be carried out free of charge, provided the product has been used strictly in accordance with the guidelines set out in this user guide.
3. Our warranty does not cover replacements, adjustments or repairs which may be required as a result of normal wear and tear, wilful or accidental damage, misuse, neglect or any other cause which is beyond the control of Chiltern Invadex.
4. Modifications and repairs made to this product by unauthorised persons will render the warranty void.
5. Only parts manufactured or approved by Chiltern Invadex shall be used to repair this product. Use of unauthorised parts will invalidate all warranties and remove all liability from Chiltern Invadex for the safety of this product.
6. Chiltern Invadex shall in no event be liable for any damages, costs or expenses arising from any claim made under this warranty (save for any legal liability of Chiltern Invadex for death or personal injury resulting from the company's negligence in respect of its products).
7. This warranty does not affect your statutory consumer rights.

The below space can be used to store details of your maintenance contractor, if the equipment has been provided by a third party for example the Local Authority loan store, this information will be available from them.

Contractor name: _____

Contact number: _____

Account number: _____

Serial number: _____

ShowerTrolley



Chiltern Invadex (UK) Limited
Unit 6C
Thorpe Drive
Banbury
OX16 4UZ
UK



+44 (0)1869 365500



sales@chilterninvadex.co.uk



www.chilterninvadex.co.uk

To request a copy of this guide in large print
please contact
customer services on 01869 365500 opt 1 or
email: sales@chilterninvadex.co.uk



FM553189